



# Stall 245 EOI Prospectus: Tarot Under the Stairs

Submit an Expression of Interest  
to be part of the iconic  
South Melbourne Market



[southmelbournemarket.com.au](http://southmelbournemarket.com.au)

# South Melbourne Market

---

## The Quintessential Village Market

With over 5.5 million visitors annually, the South Melbourne Market has, and continues to, set the standard in placemaking and has delivered consistent growth in visitation over the past decade. Since 1867, the Market has been a treasured inner-city landmark and a favourite among locals and visitors. It is the quintessential village market, a place where people come not only to purchase fresh food, but to meet, eat, drink, shop, discover, share, and connect.

Inside our Market, authentic traders display their wares with pride and passion. Quirky and playful characters are found behind the counters, delivering old fashioned customer service with a smile. We embrace and showcase the local, supporting local farmers, artisans, and producers. It is a foodie's paradise where freshness, quality and diversity are paramount and foodstuffs from land and sea are on show. We celebrate a philosophy of real food, encouraging you to cook dishes made from great quality, fresh produce sourced from our family of traders you know, love and trust.

We are home to seriously good coffee, specialty tea and a vibrant restaurant precinct for day and night-time activation. There is also an amazing array of merchandise and services with everything from clothing, homewares and second-hand books to hairdressing and pet food. With a calendar of live music, events and activities, the Market is a happy and experiential place that celebrates the senses. Take a trip to the Market: you never know what you will find, but we guarantee it will be full of surprising moments and experiences!

South Melbourne Market is owned and operated by the City of Port Phillip and advised by a Special Advisory Committee of the Port Phillip Council.

The South Melbourne Market Committee has the responsibility of overseeing the Market on behalf of Council.

# Stall 245 - Location & Details

## Details :

- **Category:** General Merchandise (Non-food or beverage area) Tarot/ Fortune reader
- **Stall location:** Aisle E, close to Centre Aisle and the SO:ME Space, underneath the car park stairs
- **Trading hours:** Currently four days :
  - Wednesday 8am – 4pm
  - Friday 8am – 5pm
  - Saturday 8am – 4pm
  - Sunday 8am – 4pm
- **Size:** Approx 8.5m2

## Licensing, fees and stall details:

- **Licence Term:** 3-year licence term
- **Proposed Form of Agreement:** South Melbourne Market Licence
- **Permitted Use:** Tarot and spiritual readings and associated products.
- **Fixtures and Fittings:** A new fit-out will be required, please provide details on what your concept would be for this space including a proposed [Stall Fit-out Plan](#)
- **Rental Fees:** See fee table on page 6
- **Estimated outgoings:** The Licensee will be required to pay any metered charges for utilities.  
The licensee will also be required to pay a monthly pest control fee, amount TBA.
- The Licensee is responsible for effecting and keeping a **Public Liability insurance** policy for at least \$20 million for their stall.
- **Security Deposit:** The security deposit is equal to three months licence fee excluding GST. and will be required to be paid at the commencement of the licence.



# Stall 245- Map Location

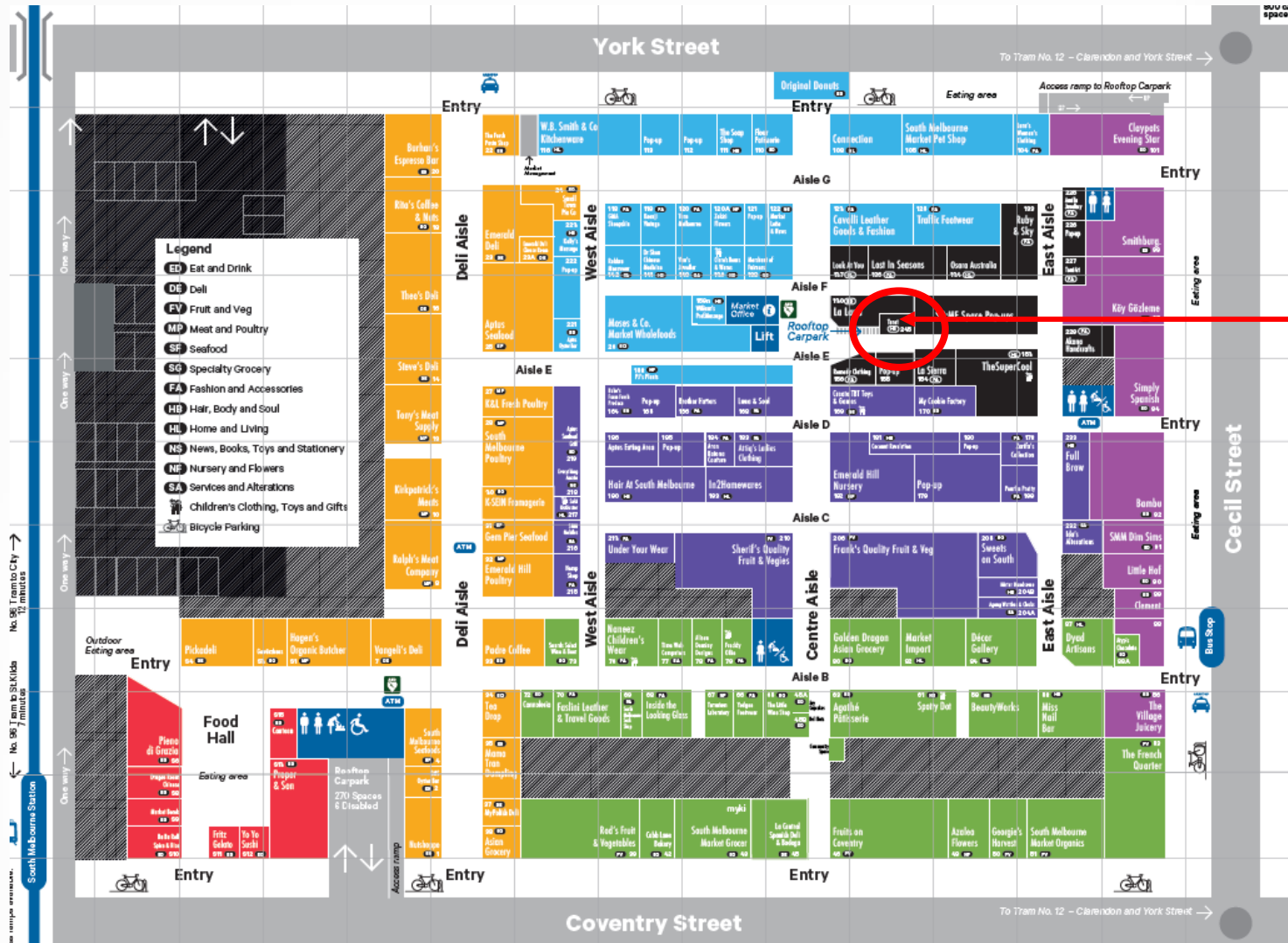

**STALL 245**  
Aisle E, under the car  
park stairs.  
Close to Centre Aisle and  
The SO:ME Space Precinct

## Stall Prospectus

# Stall 245 - Precinct

### Aisle E/Centre Aisle - Precinct overview

Stall 245 is located under the stairs to the car park in the Market's busy Aisle E, positioned close to Centre Aisle and the SO:ME Space Precinct.

Aisle E is known for its hustle and bustle, a mix of general merchandise, such as Greener Corner plant stall, Moses & Co Wholefoods and The Emel Store. It is also the passageway to the incredible seafood offer at Aptus Seafoods and through to the Deli Aisle.

This aisle acts as a major thoroughfare for customers from Centre Aisle and carpark lift and stairs, and passageway through to the SO:ME Space new business incubator precinct.

### Features:

- A vibrant precinct with a loyal customer visitation
- Quality, complementary concepts and Market retailers
- **Good location** - Central Market location close to busy Centre Aisle
- **Good footfall** - Total entry into the Market was 5,538,000 for the 23-24 year, with approx. **1,036,397 people walking past Stall 245** in Aisle E
- Approximately **19% of total visitation** annually pass the tenancy



# Stall 245 - Rental & Floorplan

Stall 245	Tarot Under The Stairs
-----------	------------------------

Commencement	Year 1 1 July 2024 To 30 June 2025	Year 2 1 July 2025 To 30 June 2026	Year 3 1 July 2026 To 30 June 2027
Annual Fees (incl GST)			
Stall fee increase on previous year		3.65%	3.65%
Stall Area Fee	\$ 12,698.28	\$ 13,161.77	\$ 13,642.17
External Area Fee	\$ -	\$ -	\$ -
Display Area Fee	-	-	-
<b>TOTAL incl GST</b>	<b>\$ 12,698.28</b>	<b>\$ 13,161.77</b>	<b>\$ 13,642.17</b>
TOTAL excl GST	\$ 11,543.89	\$ 11,965.24	\$ 12,401.97
GST	\$ 1,154.39	\$ 1,196.52	\$ 1,240.20
Monthly Fees (incl GST)			
Stall Area Fee	\$ 1,058.19	\$ 1,096.81	\$ 1,136.85
External Area Fee	\$ -	\$ -	\$ -
Display Area Fee	\$ -	\$ -	\$ -
<b>Total</b>	<b>\$ 1,058.19</b>	<b>\$ 1,096.81</b>	<b>\$ 1,136.85</b>

The above table is the agreed valuation rental fees for Stall 245

## Floorplan:

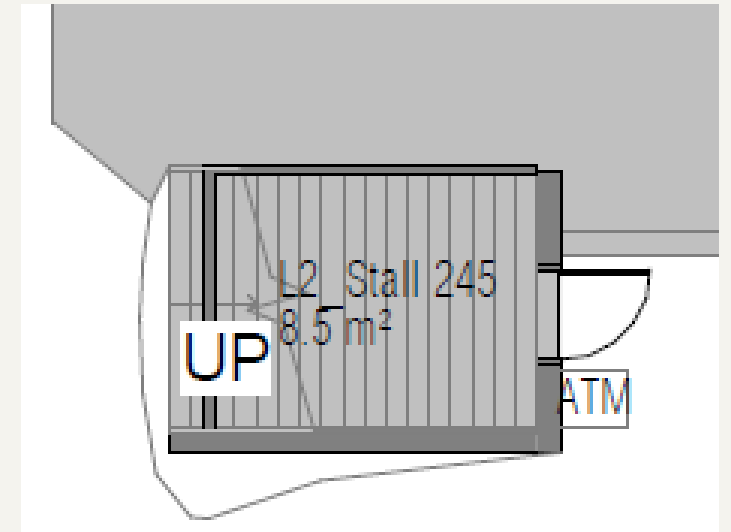

# Stall 245 - Application requirements

## Registering your interest

Interested parties are invited to express their interest by submitting an application, supported by a Business plan which focuses on the following:

- Strong focus on a viable, commercial operation
- Proposed business strategy
- Experience – details around:
  - background and previous relevant experience,
  - small business experience,
  - small business management and/or ownership
  - understanding of product innovation and trends,
  - future vision
- A passion for sustainability in business, environmental and social sustainability business strategies
- Best practice, creative and innovative business operations
- A desire to join the thriving and unique South Melbourne Market community



# Stall 245 - EOI Process

---

## Expression of interest process

Interested parties are invited to express their interest by submitting an application, supported by a [Business plan](#) which focuses on the following:

1. Applicants to read and understand all documentation.
2. Develop Business Plan: a link to a template is available on the [South Melbourne Market website](#) or you can develop your own addressing the information requested in the template.
3. Fill out and submit the application form online via the Market website before the expression of interest closing date.
4. An evaluation panel comprising of South Melbourne Market Management Team members will evaluate each application based on evaluation criteria.
5. Applicants are shortlisted and interviewed
6. SMM Management & SMM Committee support of applicant(s)
7. Successful applicant advised.
8. Licence prepared and delivered.

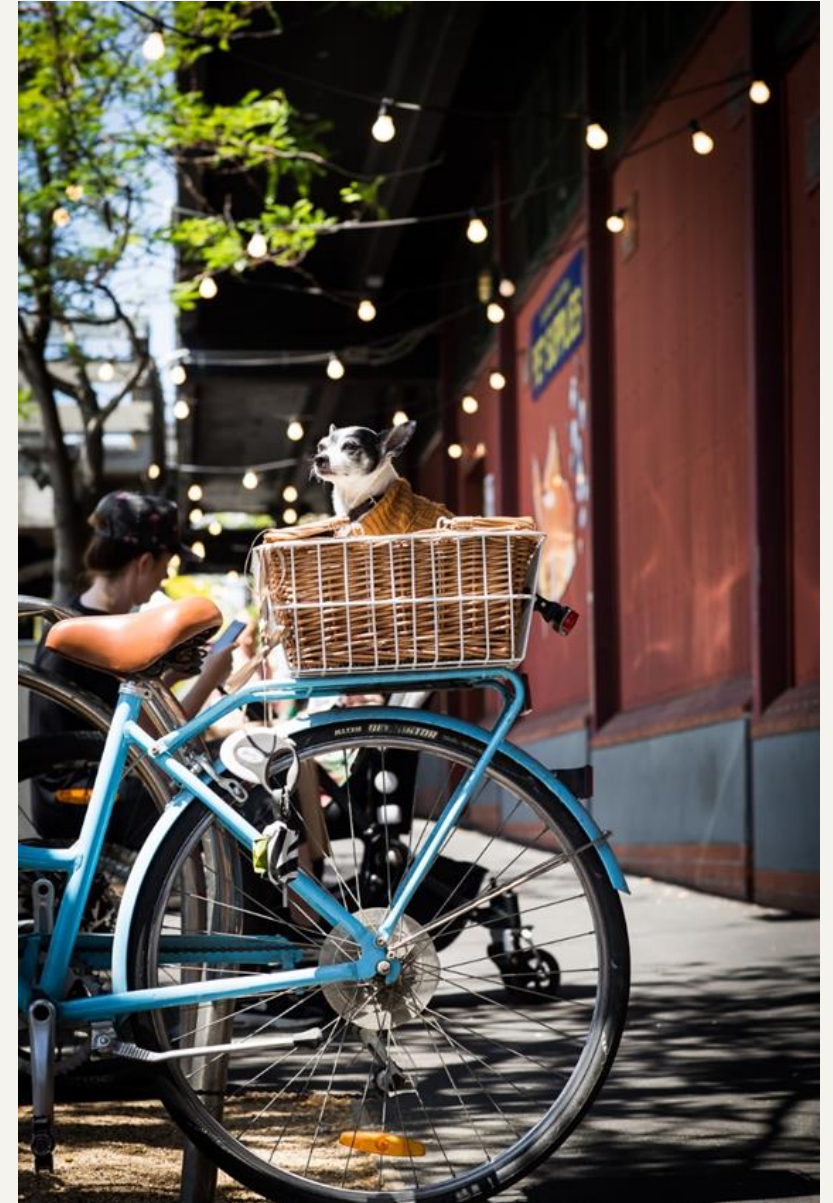



## South Melbourne Market

# Get in touch

---



South Melbourne Market Management:

**Clarissa Madden – SMM Head Of Retail & Business Development**

E: [clarissa.madden@portphillip.vic.gov.au](mailto:clarissa.madden@portphillip.vic.gov.au)

M: [0468 562 990](tel:0468562990)



Corner of Cecil & Coventry Streets, South Melbourne



[southmelbournemarket.com.au](https://southmelbournemarket.com.au)



[facebook.com/southmelbournemarket](https://facebook.com/southmelbournemarket)



[@southmelbournemarket](https://twitter.com/southmelbournemarket)

